

# B1 INSTALLATION DRAWING

IF THIS DOCUMENT IS PRINTED IN HARD COPY, IT IS FOR INFORMATION USE ONLY AND THEREFORE IS NOT SUBJECT TO UPDATING CONTROLS. ALWAYS REFER TO SOLIDWORKS VIEWER FOR LATEST ISSUE



THIS DRAWING IS CONFIDENTIAL AND IS SUPPLIED ON THE EXPRESS CONDITION THAT IT SHALL NOT BE LOANED OR COPIED OR DISCLOSED TO ANY OTHER PERSON OR USED FOR ANY OTHER PURPOSE WITHOUT THE WRITTEN CONSENT OF AP RACING LTD.

AP Racing  
Wheler Road  
Coventry  
CV3 4LB  
Tel: +44 024 7663 9595  
Fax: +44 024 7663 9559  
e-mail: sales@apracings.co.uk  
Web site: HTTP://www.apracings.com

**GENERAL DESCRIPTION**  
6 PISTON DIFFERENTIAL BORE CALIPER TO SUIT UP TO Ø355 x 35 CARBON DISC & UP TO Ø355 x 35.6 IRON DISC

**APPLICATION**  
GT CARS - SMALLER BORE VERSION OF CP6078.

**TECHNICAL INFORMATION**  
TOTAL PISTON AREA: 37.3cm<sup>2</sup>  
PISTON MATERIAL: TITANIUM  
BODY MATERIAL: ALUMINIUM ALLOY  
ASSEMBLY WEIGHT: 2.33KG

**INSTALLATION INFORMATION**  
DISC & CALIPER MOUNTING TOLERANCES TO BE SUCH THAT THE DISC IS CENTRAL TO THE CALIPER TO WITHIN ±0.5mm.  
CALIPER TO BE MOUNTED WITHIN ±15° FROM VERTICAL.  
DISC DIAMETRAL CLEARANCE SHOULD BE 2.5mm NOM. FROM DISC O.D. TO PATHWAY.

**MINIMUM WORN DISC & PAD STACK = 40.7mm**

**CALIPER PART NUMBERS**  
CP6077-4S7MP - RIGHT HAND LEADING (AHEAD OF AXLE)  
CP6077-5S7MP - LEFT HAND LEADING (AHEAD OF AXLE)  
CP6077-4S7MPD - RIGHT HAND LEADING (AHEAD OF AXLE) INC. DUCT  
CP6077-5S7MPD - LEFT HAND LEADING (AHEAD OF AXLE) INC. DUCT

DUCT KIT CAN ALSO BE ORDERED SEPARATELY, UNDER PART NUMBER CP6078-107 (NON-HANDED). SEE SHEET 2 FOR INSTALLATION DETAIL.

**NOTE: CALIPERS CAN BE USED IN A TRAILING (BEHIND AXLE) POSITION BY SWAPPING THE INLET ADAPTOR AND BLEED SCREW OVER.**

SEE SHEET 3 FOR SPARE PARTS LIST

'P' SUFFIX DENOTES CALIPER WITH PROVISION FOR PISTON CAPS. FOR PISTON CAP PART NUMBERS SEE CP6060-1PCD DRAWING.

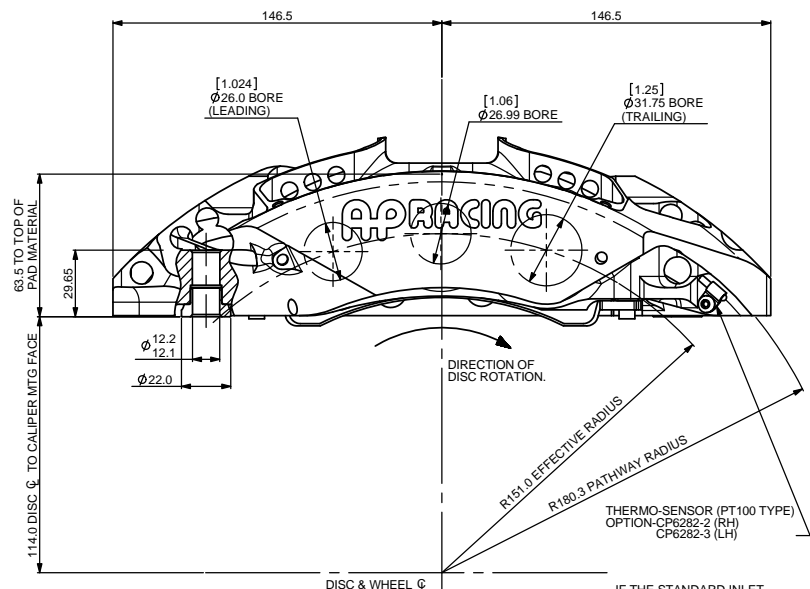
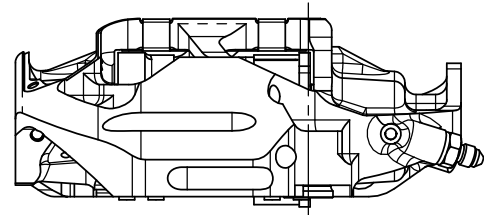

IF THE STANDARD INLET FITTING IS NOT USED, ENSURE THE REPLACEMENT HAS AT LEAST 12mm OF ENGAGEMENT IN THE PORT.

CP6300-21 DRY BREAK FITTING TIGHTENING TORQUE 13Nm. APPLY LOCTITE 270 TO THREAD UPON ASSEMBLY

FOR FURTHER DRY BREAK INFORMATION & SPARES REFER TO CP6300-13CD INSTALLATION DRAWING.

**NOTE: DRY BREAK AND INLET ADAPTOR SHOULD BE SWAPPED OVER IF THE CALIPER IS TO BE USED IN A TRAILING POSITION.**

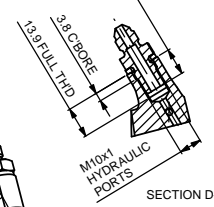

TYPICAL MTG TIGHTENING TORQUE, FOR GUIDANCE ONLY: M12 - 65Nm & M10 - 54Nm

Ø20 MIN SPOTFACE

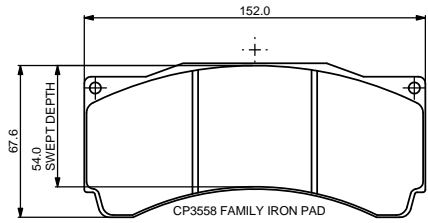
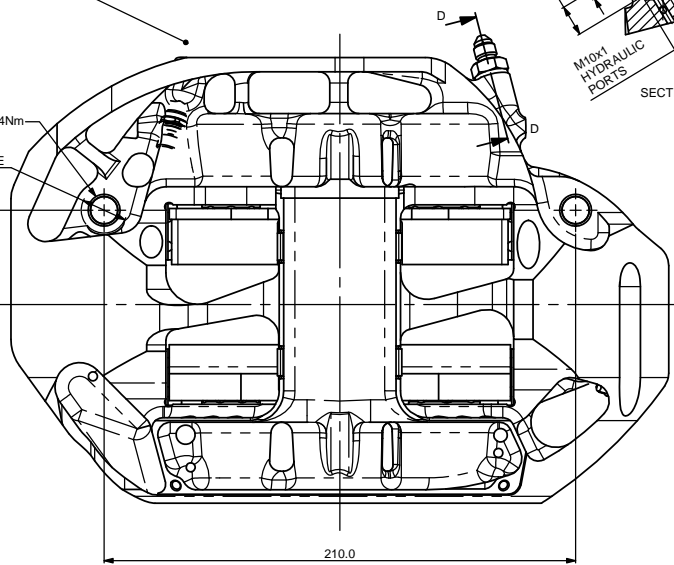

PAD AREA  
-SLOTTED: 77.43cm<sup>2</sup>  
-FULL AREA: 80.17cm<sup>2</sup>  
PAD THICKNESS: 25mm

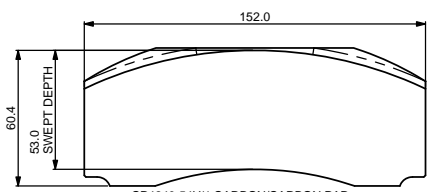

PAD AREA: 78.12cm<sup>2</sup>  
PAD THICKNESS: 25mm

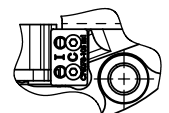

WHEN RUNNING CP3558 IRON PADS THE PAD SUPPORTS MUST BE FITTED SO THAT THE LETTERS 'T' ON THE PAD SUPPORTS FACE EACH OTHER AS SHOWN.

WHEN RUNNING CP4240 CARBON PAD THE PAD SUPPORTS MUST BE FITTED SO THAT THE LETTERS 'C' ON THE PAD SUPPORTS FACE EACH OTHER.

APR RECOMMEND THE USE OF A THREADLOCKER (LOCTITE 243 OR SIMILAR) ON THE PAD SUPPORT RETAINING SCREWS.

CARBON SET-UP = LETTERS 'C' FACE EACH OTHER

IRON SET-UP = LETTERS 'T' FACE EACH OTHER

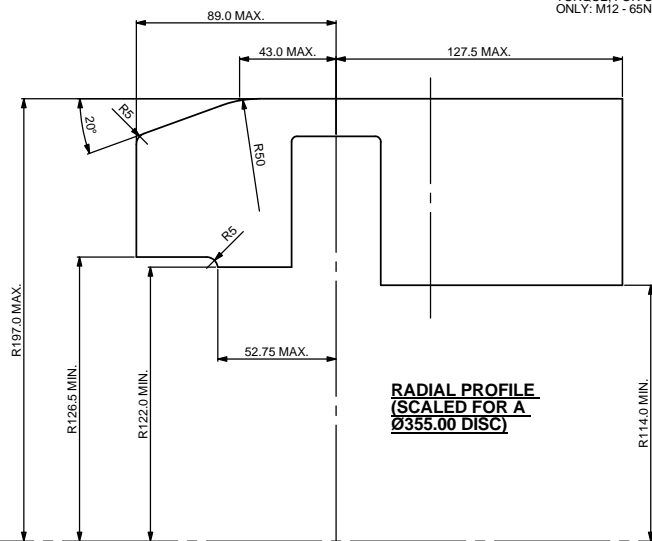

Issue No	Alterations			Zone	Initials
	Date & No.	Particulars			
1	AUG 08 B5071	FIRST ISSUE			JT
2	19 NOV 08 B5354	DUCT KIT PART # CHANGED - CP6078-107 WAS CP6078-6			JT
3	14/07/09 B5609	ALTERNATIVE PAD SUPPORT ADDED TO SPARES TABLE [SHT 3]			RLB
4	03/03/20 RAC23375_01	AP RACING LOGO MADE STRAIGHT, WAS CURVED			GN

SCALE 1:1	SHEET 1 OF 3
DRAWN Jan Tait	
APPROVED	
DERIVED FROM CP6078-1CD	
TITLE 6 PISTON MONOBLOC RADICAL GT CALIPER	
DRG NO. CP6077-1CD	

B1

INSTALLATION DRAWING

IF THIS DOCUMENT IS PRINTED IN HARDCOPY, IT IS FOR INFORMATION USE ONLY AND THEREFORE IS NOT SUBJECT TO UPDATING CONTROLS. ALWAYS REFER TO SOLIDWORKS VIEWER FOR LATEST ISSUE

FIRST ANGLE PROJECTION

THIS DRAWING IS CONFIDENTIAL AND IS SUPPLIED ON THE EXPRESS CONDITION THAT IT SHALL NOT BE LOANED OR COPIED OR DISCLOSED TO ANY OTHER PERSON OR USED FOR ANY OTHER PURPOSE WITHOUT THE WRITTEN CONSENT OF AP RACING LTD.



AP Racing  
Wheler Road  
Coventry  
CV3 4LB  
Tel: +44 024 7663 9595  
Fax: +44 024 7663 9559  
e-mail: sales@apracings.co.uk  
Web site: HTTP://www.apracings.com

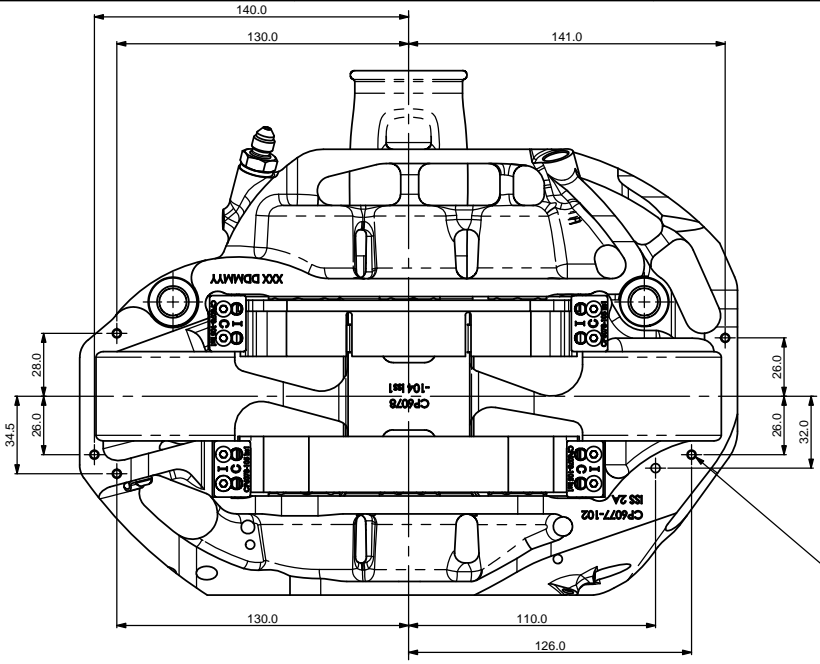

3 HOLES M4x0.7 x 8  
FULL THD EACH  
END OF CALIPER  
FOR MOUNTING  
WHEEL SCRAPER.

CARBON DUCT KIT  
CP6078-107

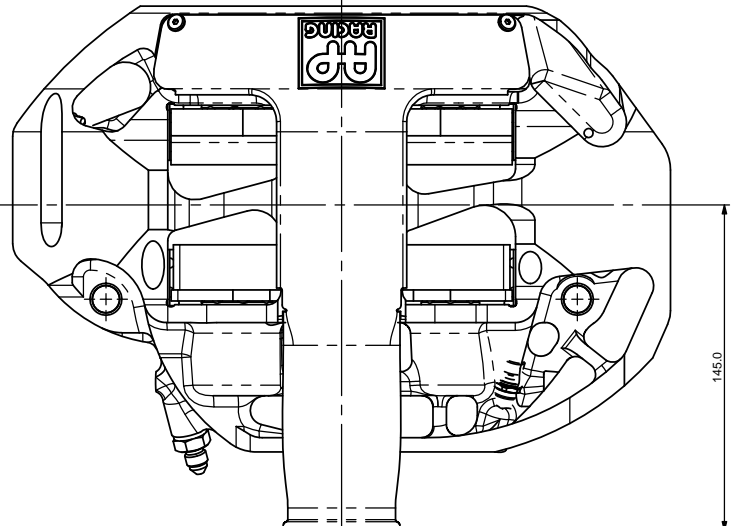
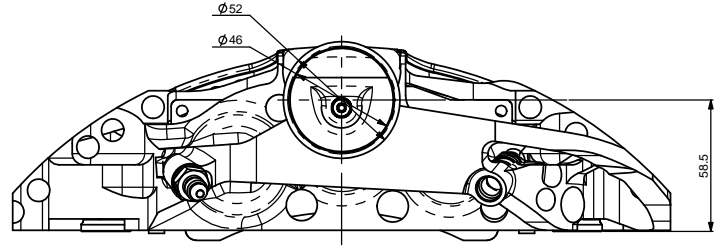
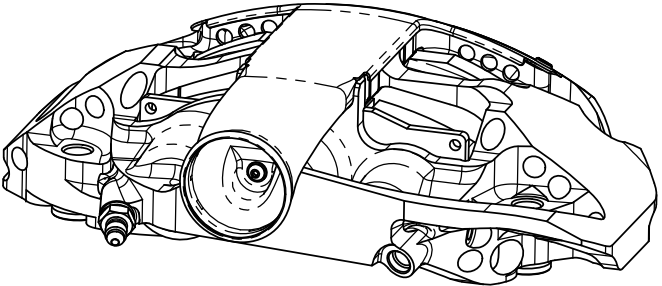
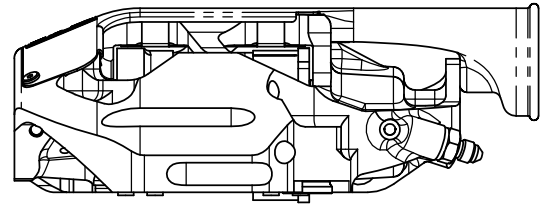
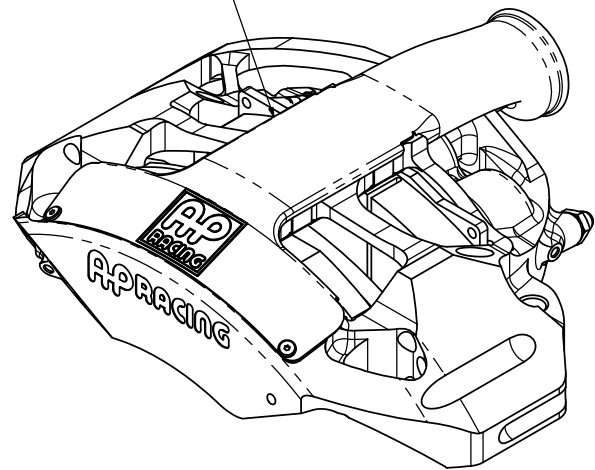

Alterations		Zone	Initials
Date & No.	Particulars		
3	SEE SHEET 1 FOR ISSUE CHANGE DETAILS		

SCALE 1:1	SHEET 2 OF 3
DRAWN Jan Tait	
APPROVED	
DERIVED FROM CP6078-1CD	
TITLE 6 PISTON MONOBLOC RADICAL GT CALIPER	
DRG NO. CP6077-1CD	

# B1 INSTALLATION DRAWING

IF THIS DOCUMENT IS PRINTED IN HARDCOPY, IT IS FOR INFORMATION USE ONLY AND THEREFORE IS NOT SUBJECT TO UPDATING CONTROLS. ALWAYS REFER TO SOLIDWORKS VIEWER FOR LATEST ISSUE



THIS DRAWING IS CONFIDENTIAL AND IS SUPPLIED ON THE EXPRESS CONDITION THAT IT SHALL NOT BE LOANED OR COPIED OR DISCLOSED TO ANY OTHER PERSON OR USED FOR ANY OTHER PURPOSE WITHOUT THE WRITTEN CONSENT OF AP RACING LTD.

**AP RACING**  
 AP Racing  
 Wheler Road  
 Coventry  
 CV3 4LB  
 Tel: +44 (0)24 7663 9595  
 Fax: +44 (0)24 7663 9559  
 e-mail: sales@apracings.co.uk  
 Web site: HTTP://www.apracings.com

SPARE PARTS LIST			
REF	QTY / CALIPER	PART NO.	DESCRIPTION
1	1	CP6518-7LBSSSS	7lb AKB SPRING KIT
2	2	CP6057-104	Ø26mm PISTON
3	2	CP6055-111	Ø1.25" PISTON
4	2	CP6055-110	Ø1.06 PISTON
5	1	CP4518-BCE	HIGH-TEMP SEAL KIT (6 SEALS)
6	1	CP6300-21	M10 DRY-BREAK CONNECTOR
7	2	CP6056-106	MOUNTING BOSS
8	1	CP6160-107	INLET FITTING
9	4	CP6075-105	WEARPLATE
10	4	CP6078-105	PAD SUPPORT
		CP6078-108	ALTERNATIVE PAD SUPPORT FOR IRON PAD SET-UP ONLY
11	8	CP3215-115	M4 SCREW
12	1	KL44517	COPPER GASKET
13	1	CP6078-104	CENTRE WEARPLATE

FOR CALIPER RE-CONDITIONING INFORMATION SEE AP RACING DATA SHEET P14.101

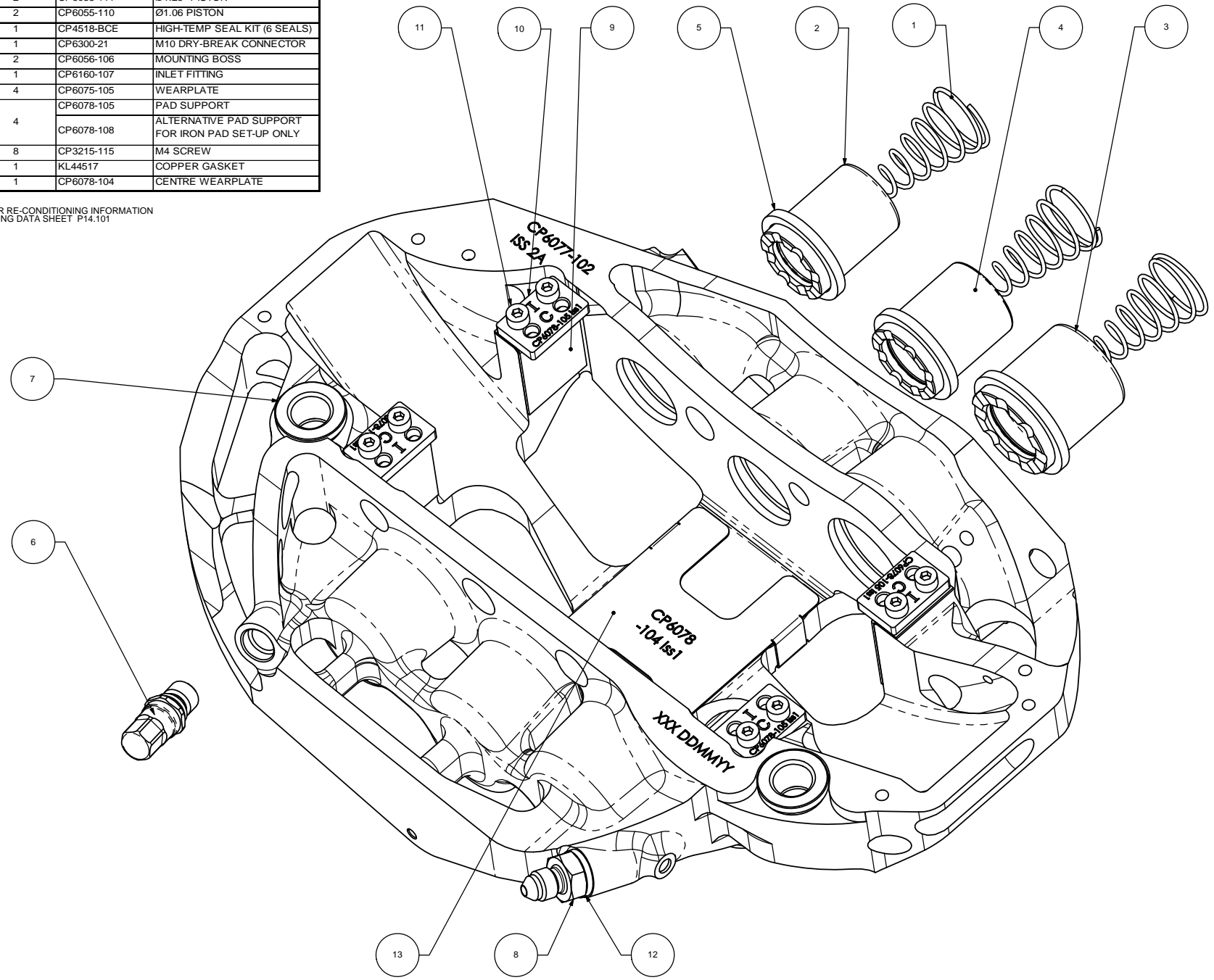

Issue No.	Alterations		Zone	Initials
	Date & No.	Particulars		
3		SEE SHEET 1 FOR ISSUE CHANGE DETAILS		

SCALE 1:1	SHEET 3 OF 3
DRAWN	Jon Tait
APPROVED	
DERIVED FROM	
TITLE	
6 PISTON MONOBLOC RADICAL GT CALIPER	
DRG NO.	CP6077-1CD